



Alabama State Port Authority
Addendum to R&P or Specification Booklet

Project Name Pier B South Sheet Pile Wall Replacement

Project 10996 Task 02

ADDENDUM #1

To: Prospective Bidders

Date: 3/22/2022

This Addendum contains the following information and becomes a part of the Bid Package.

Item	Description
1	Pre-Bid meeting attendance sheet.
2	Revised schedule of prices form.
3	Revised Bid Bond form.
4	Example Sales Tax Exemption form.
5	Clarifications to drawings and specifications
6	Responses to bid RFIs

Please indicate your receipt of this addendum by adding the addendum number in the appropriate place in your Requisition & Proposal or Specification Book.

Project Manager:

	<u>3/22/2022</u>
Marcus Coleman, P.E. Facilities Engineer	Date



Alabama State Port Authority
Pre-Bid Meeting Attendance Sheet

Project Name Pier B South Sheet Pile Wall Replacement
 3/10/2022 @ 9:00am

Project # 10996

Task # 02

Contractor (Business) Name <i>G.A. West</i>		Address 1		Address 2		City, State Zip	
Contact Name <i>Kristian Roe</i>		e-mail address <i>kristian.roe@gawest.com</i>				Telephone	
Signature <i>[Signature]</i>		Signature		Signature		Signature	

Contractor (Business) Name <i>Keller North America</i>		Address 1		Address 2		City, State Zip	
Contact Name <i>William Wright</i>		e-mail address <i>WHWRIGHT@Keller-NA.com</i>				Telephone	
Signature <i>[Signature]</i>		Signature		Signature		Signature	

Contractor (Business) Name <i>G.A. West</i>		Address 1		Address 2		City, State Zip	
Contact Name <i>RYAN GILLIVER</i>		e-mail address <i>ryan.gilliver@GAWEST.com</i>				Telephone	
Signature <i>[Signature]</i>		Signature		Signature		Signature	

Contractor (Business) Name <i>PH Const.</i>		Address 1		Address 2		City, State Zip	
Contact Name <i>Dale Hensley</i>		e-mail address <i>DHensley@PHConst.com</i>				Telephone	
Signature <i>[Signature]</i>		Signature		Signature		Signature	



Alabama State Port Authority Pre-Bid Meeting Attendance Sheet

Project Name Pier B South Sheet Pile Wall Replacement
3/10/2022 @ 9:00am

Project # 10996

Task # 02

Contractor (Business) Name		Address 1		Address 2		City, State Zip	
Robt J. Baggett inc							
Contact Name		e-mail address		Telephone		Fax	
Beau Baggett		beau @ rjbaggett.com		251-413-3290			
Signature		Signature		Signature		Signature	

Contractor (Business) Name		Address 1		Address 2		City, State Zip	
VECELLIO & Grogan							
Contact Name		e-mail address		Telephone		Fax	
BOB GUNTER		ROBERT.GUNTER@VECELLIOGROGAN.COM		813-532-7802			
Signature		Signature		Signature		Signature	

Contractor (Business) Name		Address 1		Address 2		City, State Zip	
P&H Construction							
Contact Name		e-mail address		Telephone		Fax	
Chris Hensley		chensley@phconst.com		251-433-6716		251-433-6719	
Signature		Signature		Signature		Signature	

Contractor (Business) Name		Address 1		Address 2		City, State Zip	
JORDAN Pile DRIVING							
Contact Name		e-mail address		Telephone		Fax	
Curtis Johnson		Cjohnson@jordangroup.com		251-433-6989			
Signature		Signature		Signature		Signature	



Alabama State Port Authority
Pre-Bid Meeting Attendance Sheet

Project Name Pier B South Sheet Pile Wall Replacement
 3/10/2022 @ 9:00am

Project # 10996

Task # 02

Contractor (Business) Name		Address 1	Address 2	City, State Zip	
Jordan Pile Driving					
Contact Name		e-mail address		Telephone	Fax
Charles Ernest ID		Cernest 1128@gmail.com		251-259-7454	
Signature	Signature	Signature	Signature		
Charles Ernest ID					

Contractor (Business) Name		Address 1	Address 2	City, State Zip	
Bamac Contractors					
Contact Name		e-mail address		Telephone	Fax
Dustin Talley		dustin.talley@ba-mac.com		409 299 1979	
Signature	Signature	Signature	Signature		
Dustin Talley					

Contractor (Business) Name		Address 1	Address 2	City, State Zip	
Continental Construction Continental Construction					
Contact Name		e-mail address		Telephone	Fax
Callin Ross		cross@continentalconst.com		504-398-0014	
Signature	Signature	Signature	Signature		

Contractor (Business) Name		Address 1	Address 2	City, State Zip	
JD Fields					
Contact Name		e-mail address		Telephone	Fax
Joe Tridico		jtridico@jdfields.com		985-900-6209	
Signature	Signature	Signature	Signature		
Joseph Tridico					



Alabama State Port Authority
Pre-Bid Meeting Attendance Sheet

Project Name Pier B South Sheet Pile Wall Replacement
 3/10/2022 @ 9:00am

Project # 10996

Task # 02

Contractor (Business) Name		Address 1		Address 2		City, State Zip	
APC construction		1910 Peters Rd. Harvey LA				Harvey LA 70058	
Contact Name		e-mail address		Telephone		Fax	
Wesley Dozier		Ajam.Casanova@apcconstruction.com		504-539-4260		504-324-0777	
Signature		Signature		Signature		Signature	

Contractor (Business) Name		Address 1		Address 2		City, State Zip	
APC Construction, LLC		1910 Peters Rd Harvey, LA				Harvey, LA	
Contact Name		e-mail address		Telephone		Fax	
JOEL McLAIN		joel.mclain@apcconstruction.com		504-289-6207			
Signature		Signature		Signature		Signature	

Contractor (Business) Name		Address 1		Address 2		City, State Zip	
4S Construction		10250-A Sand Ridge Rd, Churchville, AL				Churchville, AL 36521	
Contact Name		e-mail address		Telephone		Fax	
JOHN BLACKMON		john.blackmon@4-scs.com		251-648-4324			
Signature		Signature		Signature		Signature	

Contractor (Business) Name		Address 1		Address 2		City, State Zip	
4S CONSTRUCTION		10250-A SAND RIDGE RD					
Contact Name		e-mail address		Telephone		Fax	
RONNIE SIMMONS		RONNIE.SIMMONS@4-SCS.COM		251-721-4133			
Signature		Signature		Signature		Signature	



Alabama State Port Authority
Pre-Bid Meeting Attendance Sheet

Project Name Pier B South Sheet Pile Wall Replacement
3/10/2022 @ 9:00am

Project # 10996

Task # 02

Contractor (Business) Name	Address 1	Address 2	City, State Zip	
MOTT MACDONALD	107 ST. FRANCIS ST.		MOBILE, AL 36602	
Contact Name	e-mail address		Telephone	Fax
JOHNNY MURPHY	JOHN.MURPHY@MOTTMAC.COM		251-402-2170	
Signature	Signature	Signature	Signature	
				

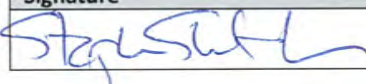
Contractor (Business) Name	Address 1	Address 2	City, State Zip	
PCL CONSTRUCTION	1 N. DALE MABRY HWY	SUITE 300	TAMPA FL 33609	
Contact Name	e-mail address		Telephone	Fax
STEPHEN SHORTRIDGE	SDSHORTRIDGE@PCL.COM		813 415 4630	
Signature	Signature	Signature	Signature	
				

Contractor (Business) Name	Address 1	Address 2	City, State Zip	
Contact Name	e-mail address		Telephone	Fax
Signature	Signature	Signature	Signature	

Contractor (Business) Name	Address 1	Address 2	City, State Zip	
Contact Name	e-mail address		Telephone	Fax
Signature	Signature	Signature	Signature	



Alabama State Port Authority

Specification Booklet

Project Name Pier B South: Sheet Pile Wall Replacement

Location Mobile, AL

Project # 10996

Task # 02

January 2022

I-1 | Page

SCHEDULE OF PRICES

Description	Est. Quantity	UOM	Unit Price	Value
1. Project Bonds and Insurance	Lump Sum	1	\$	\$
2. Mobilization/Demobilization	Lump Sum	1	\$	\$
3. Environmental Protection Measures	Lump Sum	1	\$	\$
4. Testing and Monitoring	Lump Sum	1	\$	\$
5. Construction MOT/Barriers/Fencing	Lump Sum	1	\$	\$
6. Demolition and removal (include rail salvage)	Lump Sum	1	\$	\$
7. New sheet pile wall (material only)	LF	1422	\$	\$
8. New sheet pile wall installation & misc. excavation & fill	LF	1422	\$	\$
9. New sheet pile wall concrete cap	CY	302	\$	\$
10. New concrete slab	CY	140	\$	\$
11. New Geofoam 29	CF	730	\$	\$
12. New Premolded Joint Filler	CY	50	\$	\$
13. New Concrete Flowable fill for voids	CY	1540	\$	\$
14. Select Fill	CY	150	\$	\$
15. Asphalt pavement (including base)	Lump Sum	1	\$	\$
16. Utility connections and modifications	Lump Sum	1	\$	\$
17. Allowance for additional flowable fill for unforeseen voids	CY	260	\$	\$
TOTAL BID				\$

Dollars

(In Words)



Alabama State Port Authority
Specification Booklet

Project Name Pier B South: Sheet Pile Wall Replacement

Location Mobile, AL

Project # 10996

Task # 02

January 2022

I-1 | Page

BID BOND

KNOW ALL MEN BY THESE PRESENTS, that we, undersigned, _____

_____ as Principal, and _____ as Surety, are hereby held and bound unto The Alabama State Port Authority as **OWNER** in the Penal sum of _____ for the payment of which will and truly be made, we hereby jointly and severally bind ourselves, successors and assigns. Signed, the _____ day of _____, 20____.

The Condition of the above obligation is such that whereas the Principal has submitted to the Alabama State Port Authority a certain BID, attached hereto and hereby made a part hereof to enter into a contract in writing, for the ASPA Pier B South Sheet Pile Wall Replacement in Mobile, Alabama, Project No.: 10996 Task 02.

NOW, THEREFORE,

(a) If said BID shall be rejected, or

(b) If said BID shall be accepted and the Principal shall execute and deliver a contract in the form of Contract attached hereto (Properly completed in accordance with said BID) and shall furnish a BOND for his faithful performance of said contract, and for the payment of all persons performing labor or furnishing materials in connection therewith, and shall in all other respects perform the agreement created by the acceptance of said BID, then this obligation shall be void, otherwise the same shall remain in force and effect; it being expressly understood and agreed that the liability of the Surety for any and all claims hereunder shall, in no event, exceed the panel amount of this obligation as herein stated.

The Surety, for value received, hereby stipulates and agrees that the obligations of said Surety and its **BOND** shall in no way be impaired or affected by any extension of time within which the **OWNER** may accept such BID; and said Surety does hereby waive notice of any such extension.

IN WITNESS WHEREOF, the Principal and the Surety have hereunto set their hands and seals, and such of them as are corporations have caused their corporate seals to be hereto affixed and these presents to be signed by their proper officers, the day and year first set forth above.

Principal	
By	
Surety	
By	



ALABAMA DEPARTMENT OF REVENUE
SALES AND USE TAX DIVISION
P.O. Box 327710 • Montgomery, AL 36132-7710

ST: EXC-01
8/18

Application For Sales and Use Tax Certificate of Exemption

FOR GOVERNMENT ENTITY PROJECT

This Certificate of Exemption will be limited to purchases which qualify for an exemption of sales and use taxes pursuant to Rule No. 810-6-3-.77

PROJECT INFORMATION:

PROJECT NAME		PROJECT OWNER'S FEIN (EXEMPT ENTITY)	
STREET ADDRESS OF PROJECT (CITY AND COUNTY INCLUDED)	CITY	ZIP	COUNTY

APPLICANT'S INFORMATION:

RELATION: (CHOOSE ONE)

☐ Government Entity ☐ General Contractor ☐ Subcontractor

APPLICANT'S LEGAL NAME	FEIN			
DBA	CONSUMER'S USE TAX ACCOUNT NUMBER			
MAILING ADDRESS: STREET	CITY	STATE	ZIP	COUNTY

CONTACT PERSON	BUSINESS TELEPHONE NUMBER ()
EMAIL ADDRESS	

PROJECT START DATE (PROVIDED BY GENERAL CONTRACTOR)	PROJECT COMPLETION DATE (PROVIDED BY GENERAL CONTRACTOR)
ESTIMATED START DATE (FOR APPLICANT)	ESTIMATED COMPLETION DATE (FOR APPLICANT)
WILL THE APPLICANT HAVE ANY SUBCONTRACTORS ON THIS JOB? <input type="checkbox"/> Yes <input type="checkbox"/> No If yes, please attach list.	NAME OF PARTY TO THE CONTRACT
JOB DESCRIPTION	

WILL ANY POLLUTION CONTROL EXEMPTION BE APPLICABLE? <input type="checkbox"/> Yes <input type="checkbox"/> No	ESTIMATED POLLUTION CONTROL COST \$	
TOTAL PROJECT BID AMOUNT (APPLICANT'S PORTION OF PROJECT) \$	LABOR COST (APPLICANT'S PORTION OF PROJECT) \$	MATERIAL COST (APPLICANT'S PORTION OF PROJECT) \$

REVENUE DEPARTMENT USE ONLY

PENDING DOCUMENTATION / INFORMATION:

☐ GCL ☐ SBL ☐ Contract / NTP / LOI ☐ LOS ☐ Project Dates / Breakdown of Costs

Contact Dates: _____ Received Date: _____
Forwarded for Denial: _____

PROJECT NAME

PROJECT OWNER'S FEIN (EXEMPT ENTITY)

FORM OF OWNERSHIP:

☐ Individual ☐ Partnership ☐ Corporation ☐ Multi member LLC ☐ Single member LLC ☐ Government Entity

If applicant is a corporation, a copy of the certified certificate of incorporation, amended certificate of incorporation, certificate of authority, or articles of incorporation should be attached. If the applicant is a limited liability company or a limited liability partnership, a copy of the certified articles of organization should be attached.

OWNERSHIP INFORMATION:

Corporations – give name, title, home address, and Social Security Number of each officer.

Partnerships – give name, home address, Social Security Number or FEIN of each partner.

Sole Proprietorships – give name, home address, Social Security Number of owner.

LLC – give name, home address, and Social Security Number or FEIN of each member.

LLP – give name, home address, and Social Security Number or FEIN of each partner.

NAME (PLEASE PRINT)

SIGNATURE

TITLE

DATE

REVENUE DEPARTMENT USE ONLY

PENDING OTHER:

☐ Government Entity ☐ General Contractor ☐ Not on LOS

Contact Dates: _____ Received Date: _____

Forwarded for Denial: _____

Examiner's Remarks _____

Examiner _____ Date _____

Instructions For Preparation of Form ST: EXC-01 Sales and Use Tax Certificate of Exemption for Government Entity Project

NOTE: Exemption Certificates will be issued as of the project start date or the received date of the application. If, upon receipt of the application, the project has already commenced, the certificate will be issued as of the received date of the application. Any purchases made prior to the issuance of a certificate will not be exempt.

***** Please allow 10 to 14 business days for your application to be processed. *****

In order to expedite the processing of your application, please include the following documentation when submitting your application:

Exempt Entity:

1. Signed Application
2. Copy of Executed/Signed Contract, Letter of Intent, Notice of Award, and/or Notice to Proceed

General Contractor:

1. Signed Application
2. Copy of Executed/Signed Contract, Letter of Intent, Notice of Award, and/or Notice to Proceed
3. List of Subcontractors
4. Alabama Board of General Contractor's License
5. State/County Business License (usually obtained through county probate office)
6. Any other municipal business licenses associated with the project

Subcontractor:

1. Signed Application
2. Alabama Board of General Contractor's License
3. State/County Business License (usually obtained through county probate office)
4. Any other municipal business licenses associated with the project
5. List of Subcontractors (if any)

General contractors and subcontractors:

- Any additions and/or deletions to the list of subcontractors working on a project must be submitted to the Department within 30 days of occurrence.
- If an extension is needed for a project, please contact the Department of Revenue at the address, number, or email listed below. Extension requests should be submitted no more than 30 days after expiration date.
- Subcontractor's Estimated Start Date should be the date they will begin working on the project and ordering materials instead of the General Contractor's Estimated Start Date for the project.

THERE IS A FILING REQUIREMENT IF YOUR APPLICATION IS APPROVED. The return will be filed through the Consumer's Use Tax account. Please see the following page for detailed instructions and general information regarding the reporting requirements.

The application and required documentation may be mailed, faxed, or emailed to the following:

Fax: (334) 353-7867

Email: STExemptionUnit@revenue.alabama.gov

Mailing Address: ATTN: Contractor's Exemption
Alabama Department of Revenue
Sales & Use Tax Division
Room 4303
PO Box 327710
Montgomery, AL 36132-7710

General Information and Instructions Regarding the Reporting Requirements for Contractors Awarded an Exemption Certificate

A contractor's exemption certificate for a Government Entity project is needed in order to purchase materials tax exempt for the qualified project. Once the exemption certificate has been applied for and awarded, there is a monthly filing requirement to report the purchases that have been made for each exempt project. The Consumer's Use (CNU) tax account is used to report the tax-exempt purchases made with each certificate for each exempt project for each month.

The consumer's use tax return must be filed for each of the months covered by the exemption certificate. (For example, if the certificate's effective date is June 29, 2014 and the expected completion date is October 1, 2014, a consumer's use tax return must be filed for each of the following months: June, July, August, September, and October.) A return **MUST** be filed each month to report the monthly purchases. Therefore, all active exemption certificates must be included on the monthly report even if the monthly purchases for a specific project was \$0.

If a CNU tax account is not already open under the taxpayer/business name, one will automatically be assigned at the time the exemption certificate is generated. Electronic filing is required through the Department's online filing system, My Alabama Taxes (MAT). A letter containing the online filing information will be mailed to the address on file within a few days after the new CNU tax account has been assigned. This letter will contain all the information needed to create your online filing account in MAT. For questions relating to setting up the account on www.myalabamataxes.alabama.gov, please contact Business Registration at 334-242-1584 or the Sales Tax Division at 1-866-576-6531.

Once the MAT account is set up, please log in and file the monthly CNU tax return. There is a table located at the bottom left hand corner labeled "Contractor's Exemption for Government Construction Projects." All three fields in the table are required to be completed: exemption number, project number, and total amount of purchases for that specific project for the month. Additional projects may be added on the additional rows that appear as data is added; the table will allow the addition of more projects.

***Please do not use lines 1 through 9 of the return for reporting exempt project information. Leave these lines blank unless taxable purchases were made outside of the state of Alabama that need to be reported and tax remitted. (Lines 1 through 9 do not have anything to do with the exemption reporting requirements).

When the certificate expires (upon the project's completion) and the CNU tax account is no longer needed, please contact the Business Registration Unit at 334-242-1584 and close the CNU tax account. Please be advised that if there are multiple government entity projects open, the consumer's use tax account should remain open until the last project completion date. For example, if Project EXC00ABCD ends in June of 2014 but Project EXC00EFGH ends January of 2015, the CNU tax account must remain open until the end of January 2015. A return for Project EXC00EFGH must be filed all the way through January 2015.

If the applicant already has a CNU tax account and it is currently set up online, please use this account to report exempt project purchases through www.myalabamataxes.alabama.gov using the instructions provided above. The return may then be filed as usual.

***All Consumer's Use Tax returns are due on the 20th of the month following the month in which purchases were made (i.e., the return for the month of June is due July 20th, etc. There are 20 days to file the return before it is deemed late.)

***Any penalty waiver requests may be directed to the Sales and Use Tax Division at 1-866-576-6531. Only one waiver per 18 month period is allowed.



Alabama State Port Authority

Project Name Pier B South: Sheet Pile Wall Replacement

Location Mobile, AL

Project # 10996

Task # 02

March 21, 2022

1 | Page

Addendum No. 01

Reference Drawings

General, All sheet piles: ZZ sections can be used in lieu of AZ sections of same size.

DS-07, Demolition Details: On Detail 1, revise the following note “Portion of existing 90 LB A.R.A rail series B, to be removed and stored by contractor and given to ASPA for their future use.”

MA-10, Return Wall Elevation: AZ 19-700 sheets piles are 65ft long sheets and AZ 12-770 sheet piles are 60ft long sheets.

MA-11, Return Wall Typical Sections: The existing rail to be removed will not be replaced. The concrete approach slab and precast rail sections on Detail 1 is not required. The concrete slab on Detail 2 is not required. Refer to attached typical asphalt pavement detail for their replacement.

U-03, Utility Details - Section 3: Delete in its entirety.

Reference Specifications

Division I, Invitation to Bid: Bid date has been extend to March 31, 2022. All other times and requirements remain the same.

Division I, Schedule of Prices: See attached for revised form.

Division I, Bid Bond Form: See attached for revised form with correct project number.

Division III, SP-02 Owner Purchase of Materials: The Alabama State Port Authority will utilize its sales tax exemption status on this project. The Contractor will be responsible for the purchase of all materials and will be required to apply for a sales and use tax certificate of exemption upon contract award.

Division IV, Section 20-14 – Owner Purchase of Materials:

- 20-14.2, Purchase of Materials or Equipment: Delete in its entirety.



Alabama State Port Authority

Project Name Pier B South: Sheet Pile Wall Replacement

Location Mobile, AL

Project # 10996

Task # 02

March 21, 2022

2 | Page

- 20-14.3, Payment of Materials or Equipment: Delete in its entirety.
- 20-14.4, Accounting Procedures: Delete in its entirety.
- 20-14.5, Procedures: Delete in its entirety.
- 20-14.7, Project Close-Out: Delete in its entirety.

Division III, SP-03, Commencement and Completion: Revise 270 calendar days to 365 calendar days and remove language in parentheses.

Division V, Section 09 96 26, Marine Coatings: Revise minimum DFT in tables 2.01Ba and Bb to 20 mils minimum for a total 40 mils. Add additional coating manufacturer of Sherwin Williams, Dura-Plate 154 Epoxy Splash Zone Coating using same minimum 40 mil total.

Response to RFIs

1. Is the section of track to be removed and reinstalled in concrete or asphalt?
Response: The track will be removed in order to install the new wall but will not be reinstalled.
2. You are asking to reuse the existing 90# rail and place it in a old castle tub crossing panel. There are only 2 manufacturers that make this type of crossing panels and neither one makes a 90# tub the smallest either one makes is 100# or 115#. Changing rail size is normally not a problem if the track is on ballast but being encased in concrete on the existing panels will cause one. Would you consider using a double ended gauge spaced every 2' and then do a cast in place concrete?
Response: Not required, reinstalling the rail has been removed from the project.
3. Will any of the three tracks have to be left in service while work is done on the other tracks?
Response: No, the tracks are out of service.
4. Furthest north track has girder rail, what size is this rail.
Response: Not applicable as reinstalling rail is no longer in the project.
5. Section 100 Item 100-07 states payment for stored materials will not be accepted on projects that are tax exempt. Can you please confirm this is correct?
Response: ASPA will pay for stored sheet piles only upon delivery to the site and verification by the Owner or EOR that the materials meet the project specifications. The schedule of prices has been revised to separate sheet pile material and installation.



Alabama State Port Authority

Project Name Pier B South: Sheet Pile Wall Replacement

Location Mobile, AL

Project # 10996

Task # 02

March 21, 2022

3 | Page

Contractor shall submit material procurement invoices with all pay applications for stored sheet piles.

6. Will the contractor or owner be responsible for the cost of the testing laboratory?
Response: Contractor is responsible for all third-party testing.
7. Section 31 41 16 Item 3.03A states “The contractor is responsible for transporting and stockpiling of the sheet pile on a barge for access from water.”; however, Section 01 52 00 Item 3.10A states that “Staging on the Pier shall be limited to the Relieving Platform only. No Staging on the pier outside of the Reliving Platform is allowed. Construction access to the site shall be limited to the existing Relieving Platform and by barge.” Please confirm that the contractor can transport the sheet piles by truck and store them on the relieving platform.
Response: The relieving platform is rated for a vehicular live load of an HL-93 truck and 500 psf uniform load where no voids exist underneath. Existing warehouse doors must be accessible at all times.
8. In the body of the bid bond form on page I-7, it has the project # as 10532 and the task as 03, which does not correlate with the project # or task shown on the title page. Will a new bid bond form be issued for submission?
Response: Yes, see attached
9. For the rails that need to be removed and replaced at bent 1, are the existing rails intended to be reused or will this be new material?
Response: Reinstalling rails has been removed from the project. The existing rails shall be removed, stored, and given to the ASPA.
10. Can the 270 Calendar Day duration be extended to allow sufficient time to order the sheet piles based on today’s market conditions with materials?
Response: Yes, the time is extended to a 365-calendar day duration.
11. Can ASPA provide a new coating specification? 48 mils exceed the coating manufactures maximum thickness
Response: Yes, reduce each coat to 20 mils for a total of 40 mil DFT.
12. Please confirm the construction equipment weight restrictions on the existing relieving platform
Response: Refer to response 9



Alabama State Port Authority

Project Name Pier B South: Sheet Pile Wall Replacement

Location Mobile, AL

Project # 10996

Task # 02

March 21, 2022

4 | Page

13. Due to the amount sheet pile material on the project and our market's current volatile condition concerning material will ASPA be able to release the Notice To Proceed within 5-7 days in order for the contractor to order the sheet piles?
Response: ASPA will make every effort to issue the Notice of Intent to Award to the winning bidder within 7 days of the bid opening, however the NTP can't be issued until the Contractor provides all documents required by the NOIA.
14. Can ASPA provide Rail & Utility contractors that are/have worked in the facility?
Response: Rail installation has been removed from the project. ASPA cannot provide a list of potential utility contractors.
15. Detail 1 on sheet MA-08 shows armoring and sealing the new edge of pavement with a L3x3x1/4" with nelson studs, backer rod, and sealant. Detail 3 on MA-07 shows the steel angle inset into the new pavement and existing pavement. Please confirm that the steel angle will only be required on the edge of the new pavement.
Response: Detail 1/MA-08 is in the direction of the new wall length and is only required in the new concrete slab and the detail reference indicates similar "SIM". Detail 3/MA-07 is for new joints perpendicular to the wall and requires the angle on both sides of the joint.
16. Will both flowable fill and 5000 PSI designs submitted need to be accompanied with a valid ALDOT approved BMT-75?
Response: As this is not an ALDOT project, their actual form does not have to be used, but the information on the form "Identification of Materials" and "Concrete Mix Design" has to be submitted with appropriate manufacturer's certifications.
17. Can you also tell us what the load rating is on the existing pier structure?
Response: Refer to response 9 for the relieving platform. There is no load rating for the existing pier.
18. Is the timber bulkhead missing at the entire length of the void?
Response: The majority is, but not all.
19. In the void area, will we be able to weld angle/plate to the sheet piles to support the concrete cap on the side closest to the water? If so, will that steel have to be coated?
Response: Yes, and it will need to be coated along with the welds.
20. Will we be allowed to demo the timber bulkhead down to bottom of cap before the new wall is installed?



Alabama State Port Authority

Project Name Pier B South: Sheet Pile Wall Replacement

Location Mobile, AL

Project # 10996

Task # 02

March 21, 2022

5 | Page

Response: At contractor's option. Any loss of material behind the new wall will have to be replaced with flowable fill at no additional cost to ASPA during the project.

21. DWG MA-08 Section 1 calls for 1,000 psi high density foam. Is this correct? Do you have a list of approved manufacturers and/or products?

Response: Yes, that is correct. The foam can be custom cut to any size at the plant. Below are a few manufactures, but any can be used that meet the specifications.

Universal Foam Products

Holly Mildner

Hmildner@universalfoam.com

C: 443.220.3285

O: 410.498.0000

Geofoam Concepts

Jesse Moreno

jesse@foamconcepts.net

office: (714) 693-1037

cell: (714) 863-9452

Steve Ross

steve@foamconcepts.net

office: (714) 693-1037

Insulfoam

Manufacturing Facility Sales Contact: Covering Alabama

4500 South Frontage Road Lakeland, FL 33815

Toll-Free: 800.242.8879

Telephone: 863.688.8879

22. Do you have an approved list of manufacturers and/or products for the 4" bond breaker?

Response: No, use two layers of 2" foam board.

23. As discussed at the pre-bid, please confirm that the railroad platform is condemned. If not, please provide load limits for use of the dock?

Response: Confirmed, refer to response 19.

24. Provide specifications for Bond Breaker material shown on DWG MA-08. Also confirm the thickness of material will be 4" as shown on drawing.

Response: Refer to response 22.



Alabama State Port Authority

Project Name Pier B South: Sheet Pile Wall Replacement

Location Mobile, AL

Project # 10996

Task # 02

March 21, 2022

6 | Page

25. The specifications call for the sheet piles to be coated with 48 mils DFT with each coat being 24 mils. Per Carboline Product Data Sheet, the maximum mils is 20 per coat. Please confirm the required mils per coat.

Response: Refer to response 13

26. Provide an elevation of existing utility lines that are to be cut and reinstalled after sheet pile installation.

Response: The elevation of utilities range from 3.5ft to 7.33ft. Refer to existing drawings.

27. Based on sequence the sequence shown on DWG DS-01, the timber bulkhead shall be cut off after the sheet piles are installed which leaves approximately 2" of clearance between the existing bulkhead and the new sheet piles. Would it be acceptable to remove the timber bulkhead prior to installing the sheet piles?

Response: Refer to response 22

28. The turbidity curtain requirements in the specifications, will this be required for the project?

Response: Yes

29. Will ASPA consider a bid extension?

Response: Yes, bids are extended to March 31, 2022. All times and requirements remain the same.

3 1/2" ASPHALT SUPERPAVE TRAFFIC LEVEL C
(2" SP12.5 LIFT TO BE PLACED DURING CONSTRUCTION,
REMAINING 1 1/2" SP9.5 LIFT TO BE PLACED AFTER ALL
CONSTRUCTION IS COMPLETED

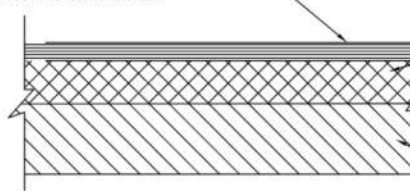

8" LIMEROCK OR CRUSHED
CONCRETE BASE LBR 100; 98% MAX.
DENSITY MODIFIED PROCTOR (FDOT
STD. SPEC. 200/204) CONSTRUCT IN
TWO 4" LIFTS

12" TYPE B STABILIZED
SUB-GRADE (LBR-40) COMPACTED
TO 98% MAX. DENSITY MODIFIED
PROCTOR

HEAVY DUTY ASPHALT SECTION

N.T.S.

PIER B SOUTH

397324

3/21/2022 4:33:39 PM

SHEET TITLE:
HEAVY DUTY
ASPHALT
SECTION
SHEET NUMBER:
SSK-01

DATE: 03/21/22
DESIGNED BY: CM
DRAWN BY: CM
CHECKED BY: LJD
PROJECT ENGINEER: L DENTY
PROJECT MANAGER: L DENTY
MOTT MACDONALD
PROJECT NUMBER: 397324

PIER B SOUTH
SHEET PILE WALL REPLACEMENT
ALABAMA STATE
PORT AUTHORITY
MOBILE, ALABAMA

M
MOTT
MACDONALD

Mott MacDonald
107 St. Francis Street
Suite 2900
Mobile, Alabama 36602
United States of America
Telephone: (251) 343-4366
www.mottmac.com/americas